

Hayberries Nature Reserve

What is special?

Hayberries is a reclaimed sand and gravel quarry which is now a haven for wildlife. Parts of the quarry cliffs have been retained and put to good use by a colony of sand martins which arrive from Africa at the end of March. They set up home by burrowing into areas of hard sand found along the old quarry face to the west of the site. This part of the site is fenced to prevent disturbance to the birds. Please do not climb over the fence, the sand martins can be seen quite easily from the car park as they collect nesting material.

The sandy soil is a rare habitat which contains specialist plants as well as invertebrates such as solitary bees and wasps. The grassland has many native species of wildflowers colonising the bare ground. Of particular note are a number of rare flowers of the Alchemilla family, commonly known as Lady's Mantle, some of which are only found in County Durham. The ponds attract large numbers of frogs and toads during the breeding season, along with many aquatic plants and insects. The woodland at the eastern end of the site is mainly sycamore with a few old oak and elm trees. You may see a variety of birds including long-tailed tits, woodpeckers, tree-creepers and heron. Buzzards circle the skies above, along with curlew and lapwing.

[more info...](#)

Contact the Countryside Service

telephone: 0191 372 9100

email: countryside@durham.gov.uk

www.durham.gov.uk/countryside



Area: 15 acres (6 hectares)

Grid Reference: NZ 991 229

Map: Ordnance Survey Explorer OL31

Directions:

Approx 29 miles southwest of Durham City centre. Site is located on B6281 between Egleston and Mickleton, approx 1.5 miles west of junction of B6281 and B6282 at Egleston, signposted from the road.

Nearest postcode for GPS purposes DL12 9EQ

Parking:

Small car park, no disabled parking bays

Public Transport:

Service numbers 95, 96 (Arriva) to Egleston or Romalldirk villages. Approximately 1 mile walk on country roads to entrance

Dogs:

Allowed under control. During bird nesting season (March to August) dogs must be kept on a lead. Please clean up after your dog

Designation:

Nature reserve, UK Woodland Assurance Scheme certified, part of the site is a Local Wildlife Site

Suitable for:

Walkers and families

Habitats:

Ponds, wet grassland, woodland, sand quarry

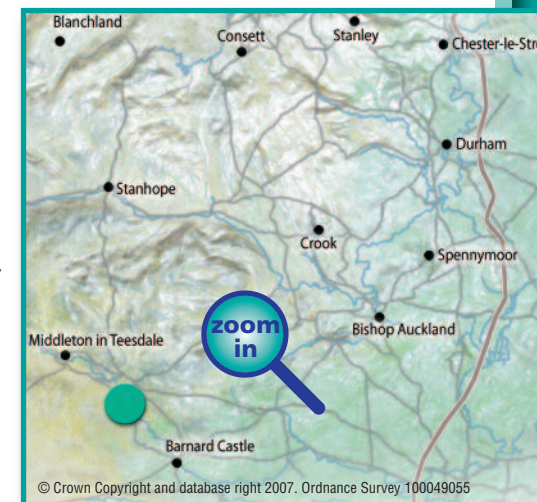

Whilst every effort has been made by Durham County Council to ensure accuracy of information, the Council cannot accept any liability resulting from omissions or inaccuracies.

Hayberries Nature Reserve

Accessibility statement

The car park is tarmaced. There are no specific paths but a 0.6 mile (900 metres) route can be followed around the site.

This route consists of bare earth and grass and is uneven and narrow. There are various gradients but only those which are particularly steep are marked.

The quarry slopes are very steep so please do not access the restricted area.

There are several picnic tables.



Sand Martin



Tree Creeper



Solitary Wasp



Heron



Alchemilla

[back](#)

Hayberries Nature Reserve

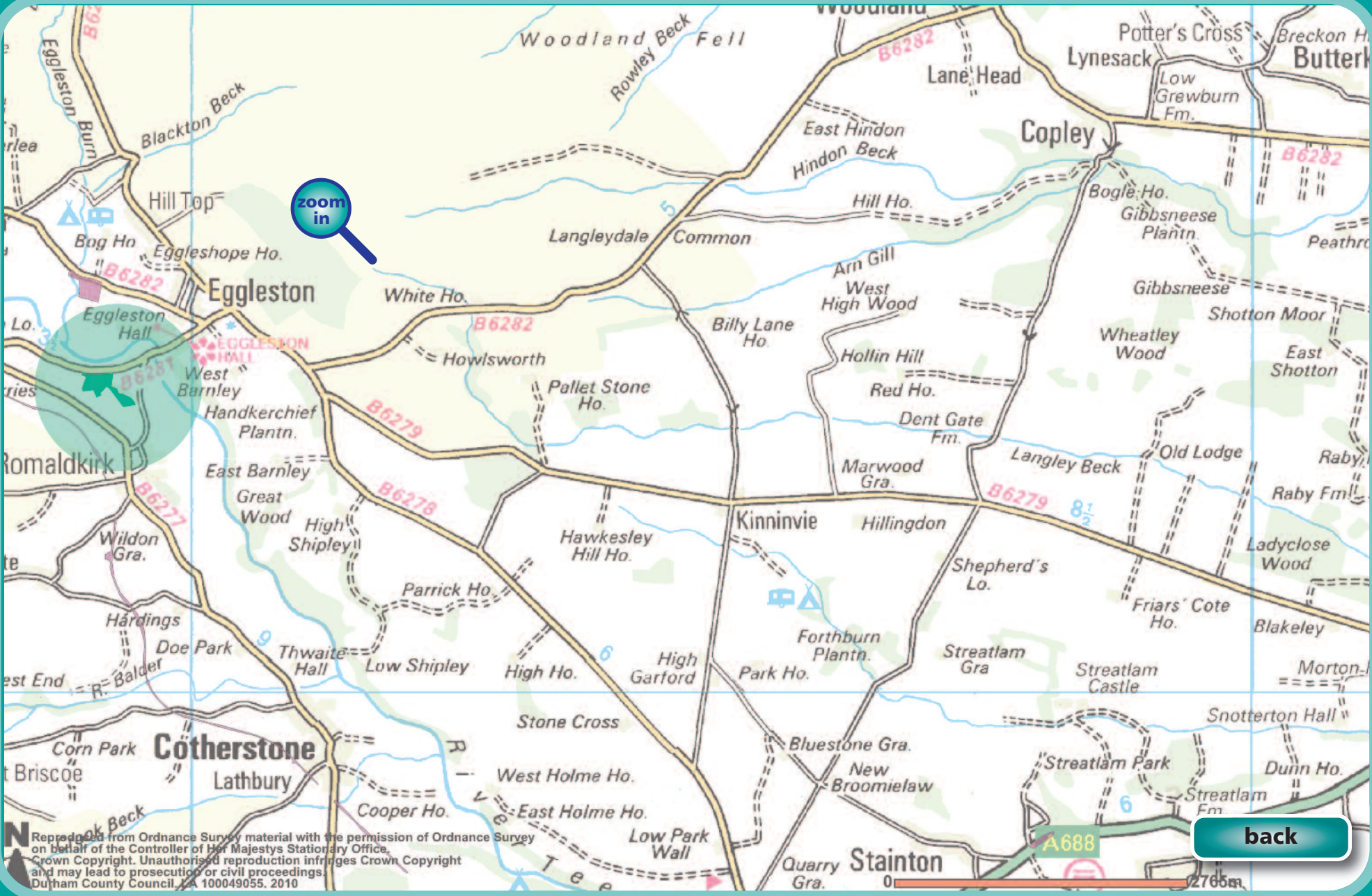

[back](#)

Hayberries Nature Reserve

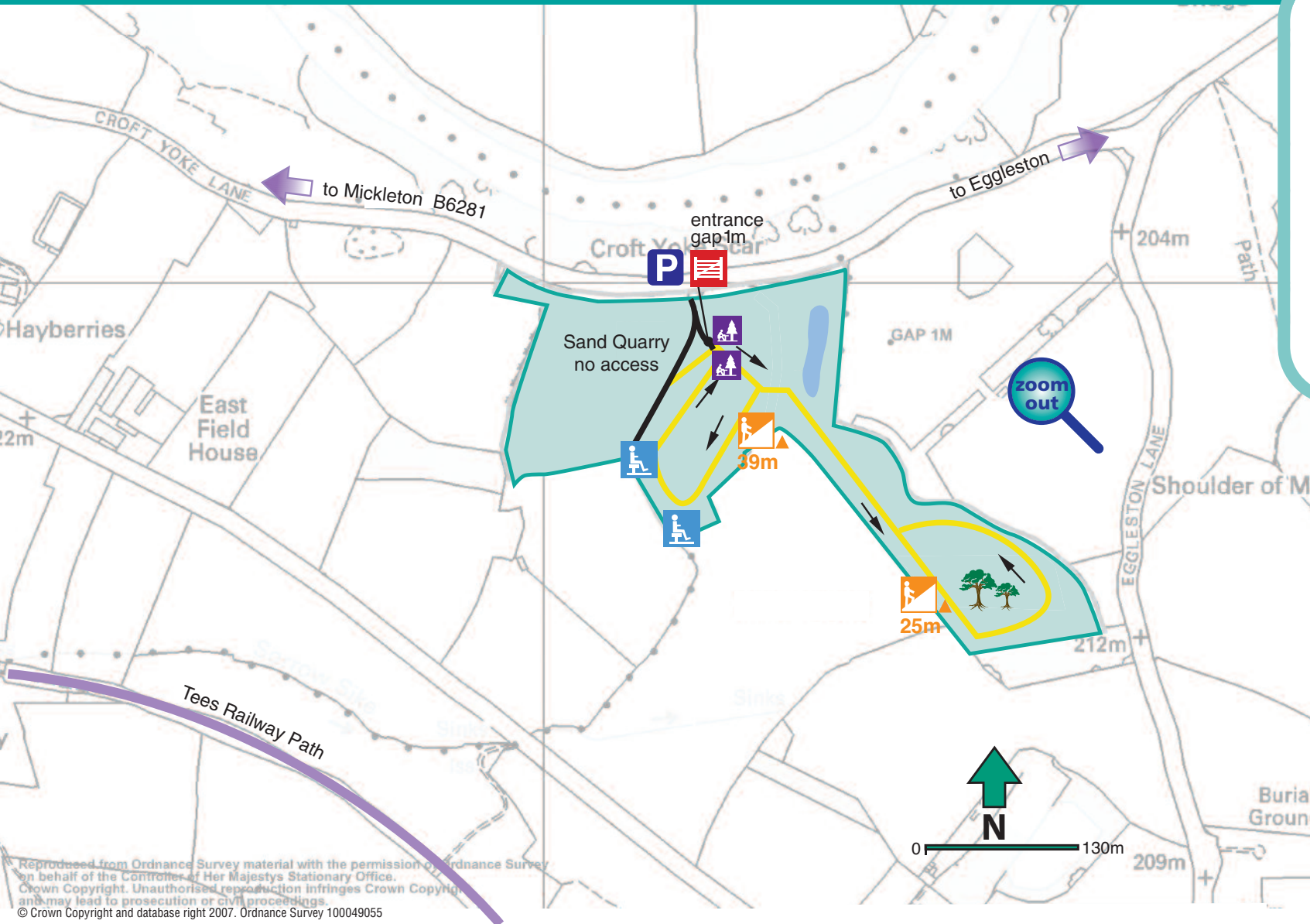

KEY

-  Picnic Area
-  Seat
-  Steep Slope Up 1:10-1:1
-  Parking
-  Gate
-  Direction of Travel
-  Hard Unsealed Surface

[back](#)

Reproduced from Ordnance Survey material with the permission of Ordnance Survey on behalf of the Controller of Her Majesty's Stationary Office. Crown Copyright. Unauthorised reproduction infringes Crown Copyright and may lead to prosecution or civil proceedings. © Crown Copyright and database right 2007. Ordnance Survey 100049055